

Data sheet F12 180° Rotation

Metric - DIN3337

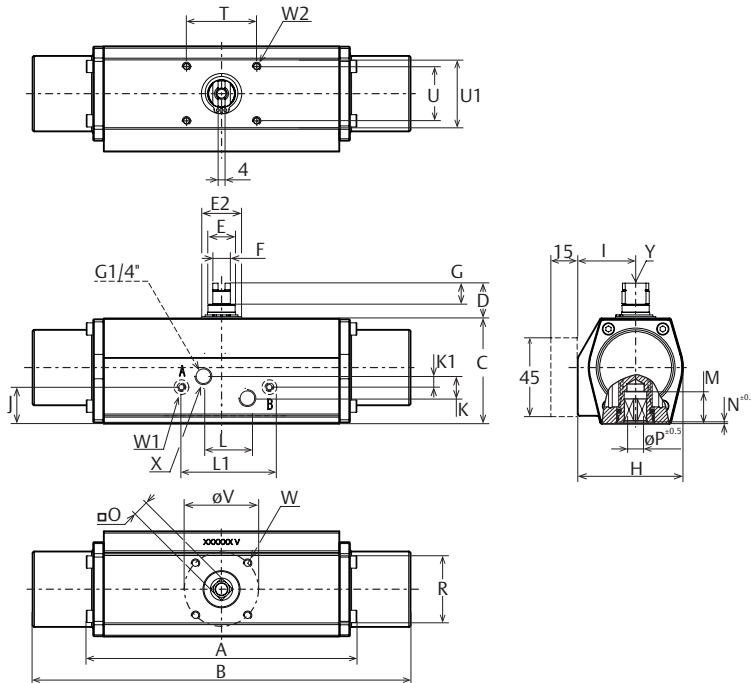

Dim. in mm		Size 12																		
A (FD)	B (FS)	C	D	E	E2	F	G	H	I	J	K	K1	L	L1	M	N	O max.	O min.	P	
155	216	60	20	16	23	10	12	60	33	21	12.7	6.4	25.4	50.8	16.5	1	9.14	9.05	12.1	
R	R1	T	U	V	W	W1	W2	X	Y											
40	40	40	31	42	M6x8	M4x5	M4x5	G1/8"	M6x12											

Principle		
Pneumatic rack & pinion actuator		
General Data		
Bore		46 mm
Stroke		25.2 mm
Weight	SR ⁽³⁾	0.99 kg
	DA ⁽³⁾	0.84 kg
Volume	Port A	0.13 L
	Port B	0.11 L
Air connection		2x 1/8" BSP
Pressure range	MOP ⁽³⁾	8.3 barg
	SR ⁽³⁾	3-8.3 barg
	DA ⁽³⁾	0.2 - 8.3 barg
Pressure media	Clean, dry or lubricated air or inert gas.	
Cycle speed DA ⁽²⁾	Open	0.5 Sec.
	Close	0.4 Sec.
Cycle speed SR ⁽²⁾	Open	0.5 Sec.
	Close	0.4 Sec.
Temperature range	-20 °C to +80 °C	
Lubrication	Lubricated for life ⁽¹⁾	
Rotation angle	180°	
Finish	Polyurethan powder coat	

1. According EN 15714-3.
2. Test conditions:
Solenoid with flow capacity: 0.6 m³/hr;
Pipe diameter: 6 mm; Medium: clean air,
Supply pressure: 5.5 barg ~ 80 psig;
Load: with average load; Stroke: 90°;
Temperature: Room temperature
3. SR = Spring-Return, DA = Double-Acting
MOP = Maximum Operating Pressure

Torque Output F12 180°																				
Spring-Return																				
Spring set	Spring Stroke Torque		Air Stroke Torque (Nm)																	
			3.0 barg		3.5 barg		4.0 barg		4.5 barg		5.0 barg		5.5 barg		6.0 barg		7.0 barg		8.0 barg	
	Start	End	Start	End	Start	End	Start	End	Start	End	Start	End	Start	End	Start	End	Start	End	Start	End
20	7.1	4.5	-	-	-	-	5.2	2.1	6.5	3.4	7.8	4.7	9.1	6.0	10.4	7.3	13.0	9.9	15.6	12.5
Double-Acting			7.3		8.5		9.7		10.9		12.2		13.4		14.6		17.1		19.6	

Notes:

- Volume is the actual free air volume at 1 atm
- Flange and square drive to ISO5211
- For further information regarding options, materials, certifications and additional execution please contact your Regional Sales Office.

European Directives:

- PED: Suitable for use with group 2 gases according to Pressure Equipment Directive (PED) 2014/68/EU
- ATEX: Suitable for use in hazardous areas classified II 2 GD, zones 1 or 2 (gases) and 21 or 22 (dust) according to ATEX Directive 2014/34/EU
- For the Configuration Code please consult EFG.02.01.EN